

Quick Connect Ejector Rods

Fast, Simple and Easy-to-Use

Dramatic Reduction in Change Time!

No Tools or Effort Required!

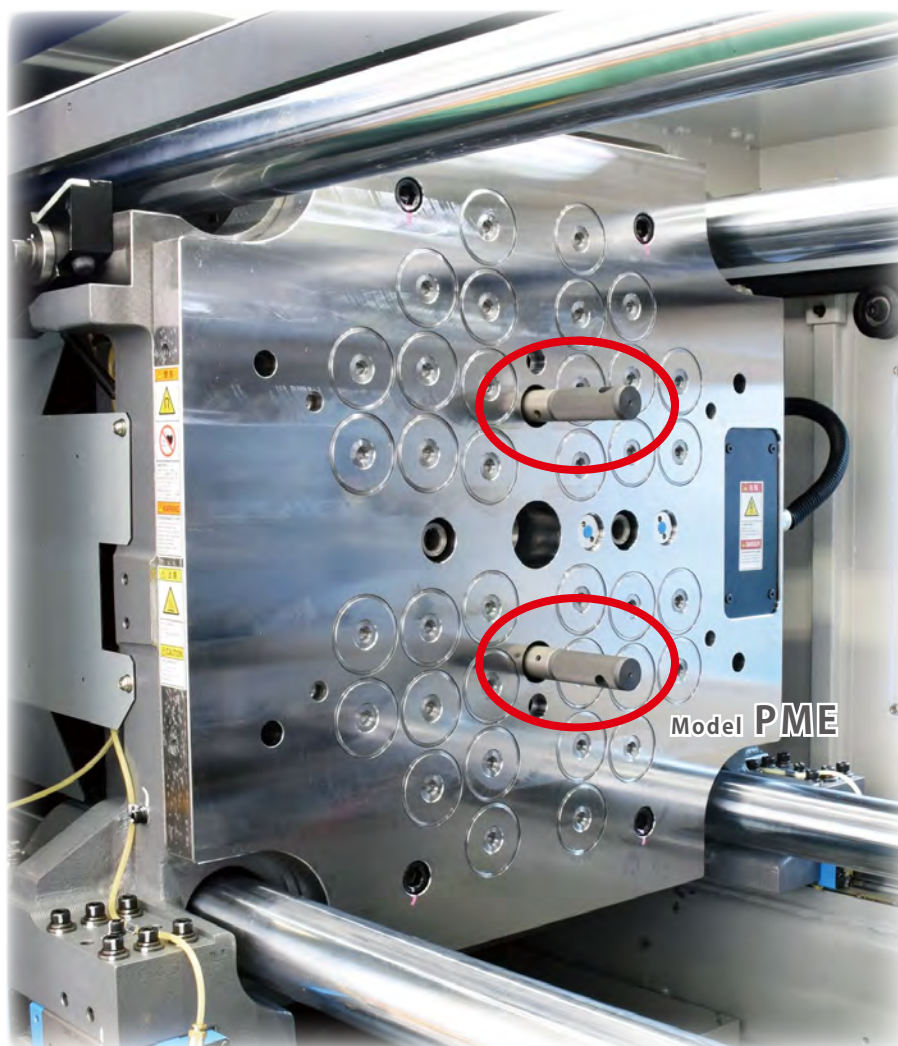

Quick Connect Ejector Rods

Model PME

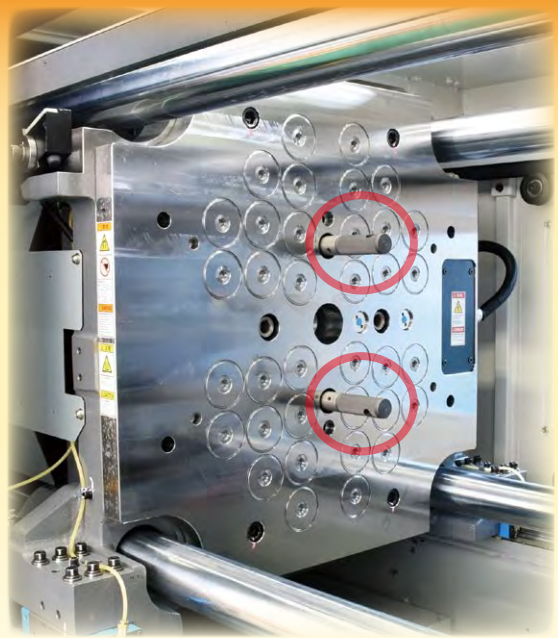

The ejector rod has been divided into a base rod and an attachment rod for **speed, simplicity and ease-of-use** when changing ejector patterns. No tools are required, allowing changes **in mere seconds**.

● Features

● Easy-to-Use

Divided ejector rods result in arranging ejector patterns only by pulling out and pushing in attachment rods, allowing changes in mere seconds.

● Light and Safe

Changing only the attachment rod is a light and safe operation.

● No Tools Required

No tools are required when changing ejector patterns.

● Highly Reliable

The simple mechanical structure makes for a long operating life and high reliability.

● Application Examples

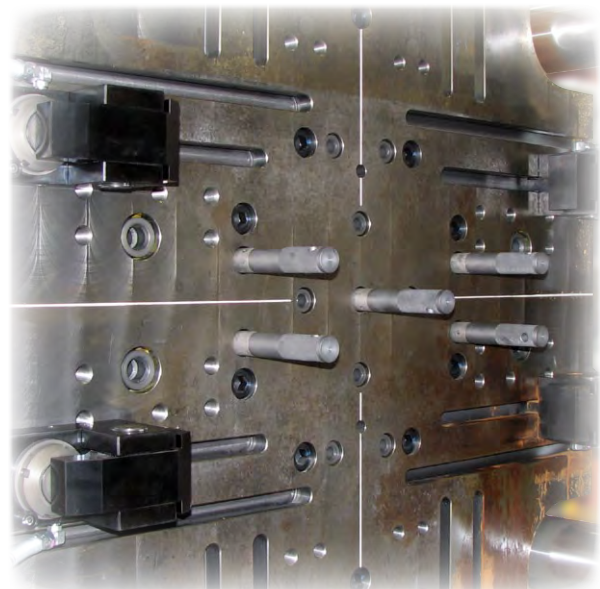
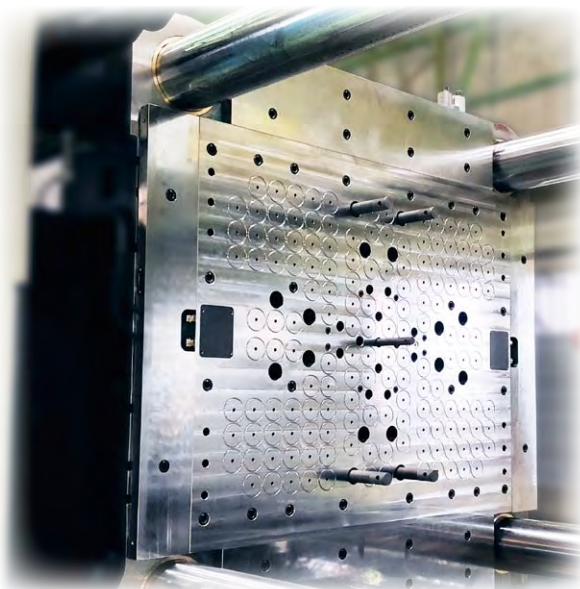

Exchange Procedure

Pull out and push in to exchange ejector rods!

① Move the ejector plate fully forward.

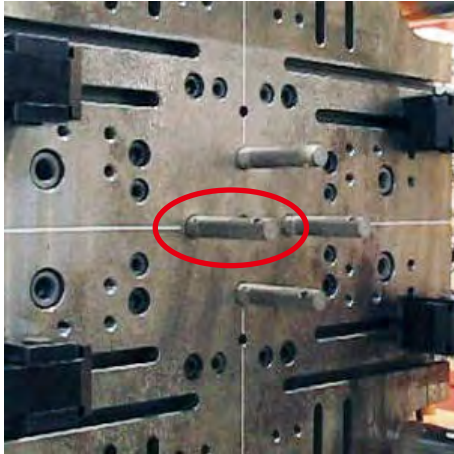

② Pull out the attachment rods manually.

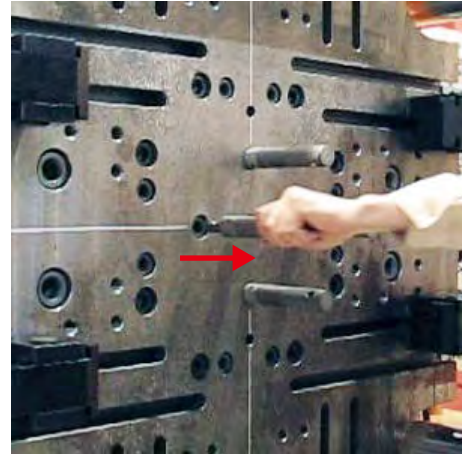

③ Arrange them in the new pattern.

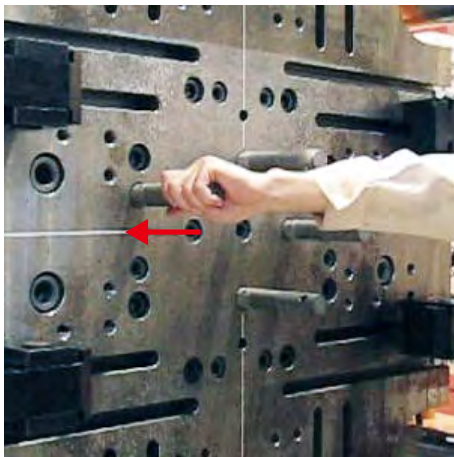

④ Ejector rod pattern change in seconds. ※1



※1. Changing time depends on the machine size, rod length and working environment, etc.

Fast, Simple and Easy-to-Use

Dramatic Reduction in Change Time!

No Tools or Effort Required!

Dramatic Improvement in Exchanging Ejector Rods!

Model No. Indication

PME **30** **B** **0** - **250** **P** **M20** **20**

1 2 3 4 5 6 7

1 Rod Diameter

25 : ϕ 25mm

30 : ϕ 30mm

45 : ϕ 45mm

※ Please contact us for any other rod diameters not listed above.

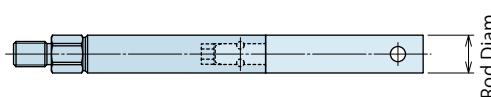

2 Rod Component

A : Attachment Rod (Removable)

B : Base Rod (Fixed)



B : Base Rod (Fixed)



A : Attachment Rod (Removable)

3 Design No.

0 : Revision Number

4 Rod Length

Attachment Rod Length (Ejector Stroke)

(Total Attachment Rod Length = Ejector Stroke + 5)

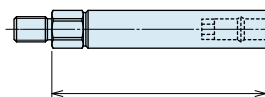

Base Rod Length

Base Rod Length (Total Ejector Rod Length - Ejector Stroke)

(Total Ejector Rod Length = Base Rod Length - 5)

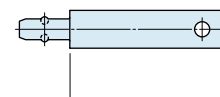

Attachment Rod Length

Notes : 1. Please contact us for the rod length.

2. Please indicate dimensions in 1mm increments.

3. Please specify the rod length, considering the offset dimensions to prevent the rod from over hanging.

Recommended offset dimension is 5mm.

4. When using a magnetic clamp or insulation board, please check the board thickness dimension and specify the rod length.

5 Thread Type (Base Rod Only)

P : Male Thread

※ For female threading, please contact us.

6 Mounting Thread (Base Rod Only)

Example : M24 = M24 Coarse Thread

※ Please specify it by metric coarse screw thread.

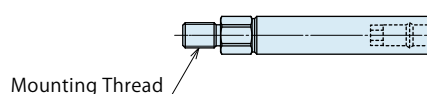

Mounting Thread

7 Thread Length (Base Rod Only)

Example : 20 = Thread Length is 20mm

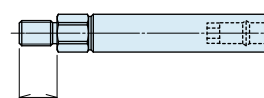

Thread Length

External Dimensions

Forward Position (Base Rod Only)

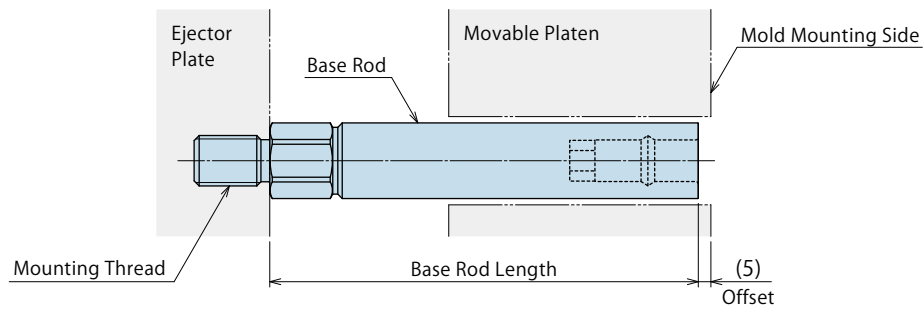

Backward Position (When Fitted)

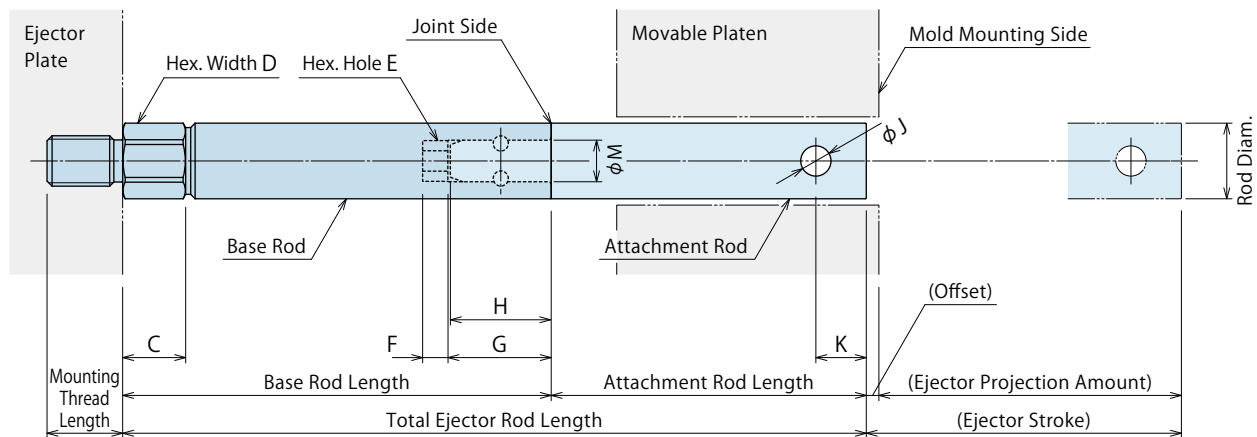

Dimension List

(mm)

Model	Attachment Rod	PME25A0-□	PME30A0-□	PME45A0-□
	Base Rod	PME25B0-□P□□	PME30B0-□P□□	PME45B0-□P□□
Rod Diameter		φ 25	φ 30	φ 45
C		25	25	30
D		22	27	41
E		14	14	19
F		10	10	15
G		41	41	51
H		40	40	50
J		12	12	18
K		20	20	30
M		16.5	16.5	26

Notes : 1. Please contact us for the rod length.

2. Please specify the offset amount according to the machine specifications and application.

3. Please contact us for more specific dimensions of individual orders.

Quick Connect
Ejector Rods

Cautions

Specifications
Sheet

Cautions

● Notes on Design

- 1) Check Specifications
 - Please use the product according to the specifications.
- 2) Please make sure that there are no contaminants on fitting side when connecting.
 - If there is a possibility that contaminants adhere to fitting side of each end, please eliminate them with air blowing. Otherwise, it may cause connection error due to the existence of contaminants.
- 3) Please avoid using in the situation that rods may be affected by eccentric load.
 - Eccentric load may cause buckling, and may break the rods.
- 4) Inclined ejector plate or deformation of ejector rod mounting bolt holes cause malfunction due to the interference between ejector rods and ejector holes of the platen.
- 5) Be careful when using PME and Magnetic Clamp together.
 - The attachment rod can be attached to the mold due to the magnetism spreading around the mold. Especially for molds without an ejector return spring, the attachment rod may detach from the base rod when the ejector rod retracts, leading to damage. Please contact us in case of the above conditions.

● Installation Notes

- 1) Installation and Removal
 - For installation and removal, tighten the base rod with a hexagonal wrench using hex key inside the base rod diameter. Make sure not to damage the joint part when tightening. (You can also tighten the base rod with a spanner from the outside of the base rod.)
- Follow the tightening torque shown in the table below.

Thread Size	Tightening Torque (N·m)
M16	100
M20	200
M24	315
M30	630
M36	1000
M39	1400

● Notes on Handling

- 1) Do not operate or remove the product unless the safety protocols are ensured.
 - ① The machine and equipment can only be inspected or prepared when it is confirmed that the safety devices are in place.
 - ② Before the product is removed, make sure that the above-mentioned safety devices are in place.
 - ③ After stopping the product, do not remove until the temperature drops.
 - ④ Make sure there is no abnormality in the respective parts before restarting the machine or equipment.
- 2) Do not disassemble or modify it.
 - If the product is taken apart or modified, the warranty will be voided even within the warranty period.

● Maintenance and Inspection

- 1) Removal of the Product
 - Before removing the product, make sure that safety devices are in place.
Make sure there is no abnormality in the respective parts before restarting the machine or equipment.
- 2) When it is difficult to remove the attachment rod.
 - When the joint part is stuck due to contaminants, take them out by putting a stick into the through hole in the side of the attachment rod.
- 3) Regularly tighten base rods to ensure proper use.
- 4) The products should be stored in the cool and dark place without direct sunshine and moisture.
- 5) Please contact us for overhaul and repair.

● Warranty

- 1) Warranty Period
 - The product warranty period is 18 months from shipment from our factory or 12 months from initial use, whichever is earlier.
 - 2) Warranty Scope
 - If the product is damaged or malfunctions during the warranty period due to faulty design, materials or workmanship, we will replace or repair the defective part at our expense. Defects or failures caused by the following are not covered.
 - ① If the stipulated maintenance and inspection are not carried out.
 - ② If the product is used while it is not suitable for use based on the operator's judgement, resulting in defect.
 - ③ If it is used or operated in an inappropriate way by the operator. (Including damage caused by the misconduct of the third party.)
 - ④ If the defect is caused by reasons other than our responsibility.
 - ⑤ If repair or modifications are carried out by anyone other than Kosmek, or without approval and confirmation, it will void warranty.
 - ⑥ Other damages caused by natural disasters or calamities not attributable to our company.
 - ⑦ Parts or replacement expenses due to parts consumption and deterioration. (Such as rubber, plastic, seal material and some electric components.)
- Damages excluding from direct result of a product defect shall be excluded from the warranty.

Specification Sheet

Quick Connect
Ejector Rods

Cautions

Specification
Sheet

If you already have ejector rods and think of replacing them with ours, please put the ejector rod dimensions in the blank below and fax it your nearest sales office.

Personal Information

Company ◆	
Name ◆	
Address ◆	〒
E-mail	
TEL ◆	
FAX	

Notes:

1. We use the personal information when confirming specifications and submitting an estimate.
2. Please fill out all the fields marked with a ◆.

Molding Machine Information

Molding Machine Manufacturer / Model	Manufacturer :	No.
	Machine Model :	

Ejector Rod External Dimensions

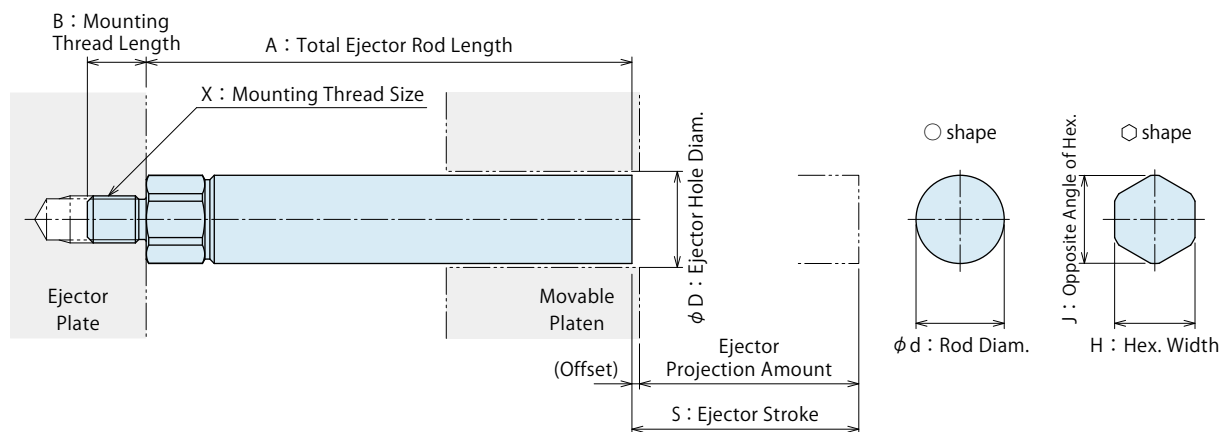

Ejector Rod Dimension Chart

Rod Diameter	★ A	★ B	D	★ d ※1	★ H ※2	★ J ※2	★ S	★ X Thread	Base Rod Required Qty.	Attachment Rod Required Qty.
for φ 25								M	rod(s)	rod(s)
for φ 30								M	rod(s)	rod(s)
for φ 45								M	rod(s)	rod(s)

Notes :

1. Please fill out all the fields marked with a ★. These dimensions are necessary for designing and manufacturing.
 2. Please specify dimensions in 1mm increments.
 3. Quick ejector rods can be damaged when using in conditions where there are damages or deformation on the female thread of the ejector plate.
- ※1. Please fill this out only when using ○-shape ejector rods.
 ※2. Please fill this out only when using ⬡-shape ejector rods.

● Installation of the Base Rods

No Special Tools Required !

- ① Align the base rod with the bolt hole in the ejector plate.

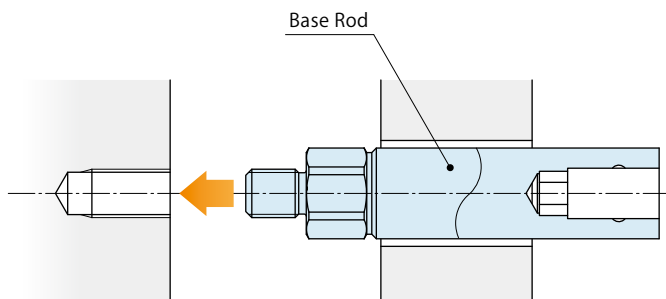

- ② The base rod can be tightened using a hex key.
(A wrench can also be used to tighten the rod.)

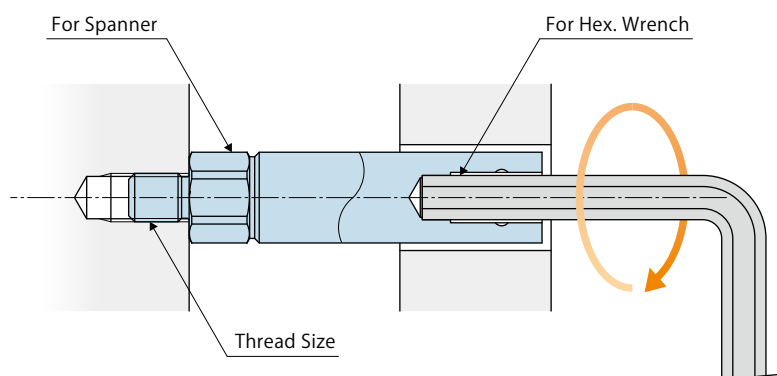

● Tightening Torque

Thread Size	Tightening Torque (N·m)
M16	100
M20	200
M24	315
M30	630
M36	1000
M39	1400



KOSMEK LTD.

► <https://www.kosmek.com/>

HEAD OFFICE 1-5, 2-chome, Murotani, Nishi-ku, Kobe-city, Hyogo, Japan 651-2241
TEL.+81-78-991-5162 FAX.+81-78-991-8787

United States of America SUBSIDIARY	KOSMEK (USA) LTD. 650 Springer Drive, Lombard, IL 60148 USA TEL. +1-630-620-7650 FAX. +1-630-620-9015
MEXICO REPRESENTATIVE OFFICE	KOSMEK USA Mexico Office Av. Santa Fe 103, Int. 59, col. Santa Fe Juriquilla, Queretaro, QRO, 76230, Mexico TEL. +52-442-851-1377
EUROPE SUBSIDIARY	KOSMEK EUROPE GmbH Schleppeplatz 2 9020 Klagenfurt am Wörthersee Austria TEL. +43-463-287587 FAX. +43-463-287587-20
CHINA SUBSIDIARY	KOSMEK (CHINA) LTD. Room601, RIVERSIDE PYRAMID No.55, Lane21, Pusan Rd, Pudong Shanghai 200125, China TEL. +86-21-54253000
INDIA BRANCH OFFICE	KOSMEK LTD. - INDIA 4A/Old No:649, Ground Floor, 4th D cross, MM Layout, Kavalbyrasandra, RT Nagar, Bangalore -560032 India TEL.+91-9880561695
THAILAND REPRESENTATIVE OFFICE	KOSMEK Thailand Representation Office 67 Soi 58, RAMA 9 Rd., Phatthanakan, Suanluang, Bangkok 10250, Thailand TEL. +66-2-300-5132 FAX. +66-2-300-5133

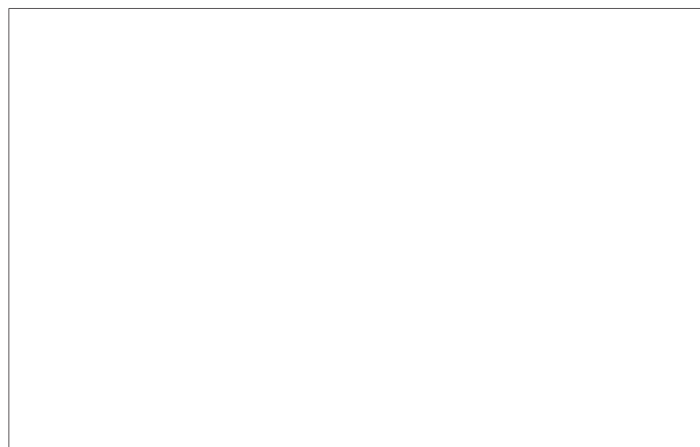

- For Further Information on Unlisted Specifications and Sizes, Please call us.
- Specifications in this Leaflet are Subject to Change without Notice.

