

New

Ejector Coupler Center Pull Back

Manual to Automation!

**For Cycle Time Reduction / Toolless Setup /
Setup Time Reduction / Product Improvement**

Ejector Coupler

Model **PMC**



Center Pull Back

Model **PMD**



For Injection Molding Machine

Ejector Coupler

Model PMC



Center Pull Back

Model PMD



Manual to Automation!

Drastically reduce the setup time. Ball Lock Joint for Powerful Connection

● Advantages

- **One Touch to Connect Ejector Rod**
- **Setup Time Reduction**

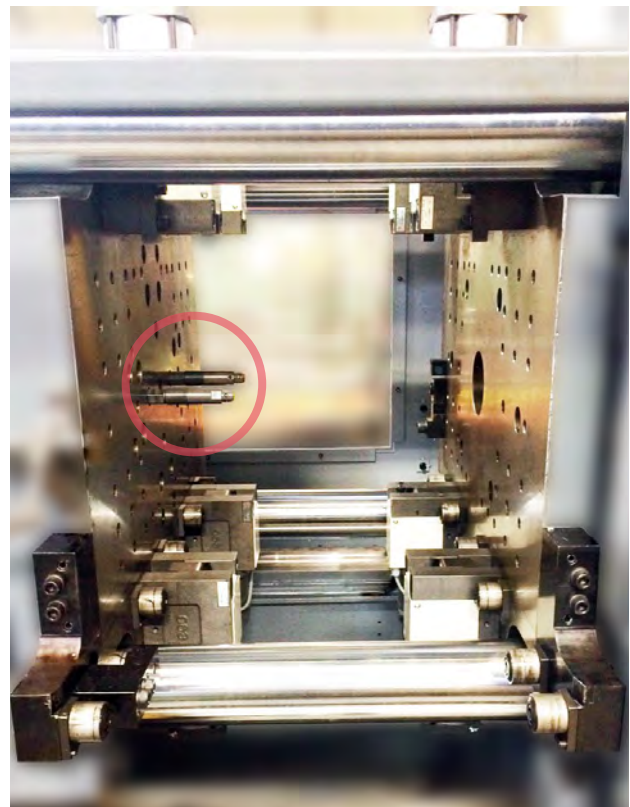
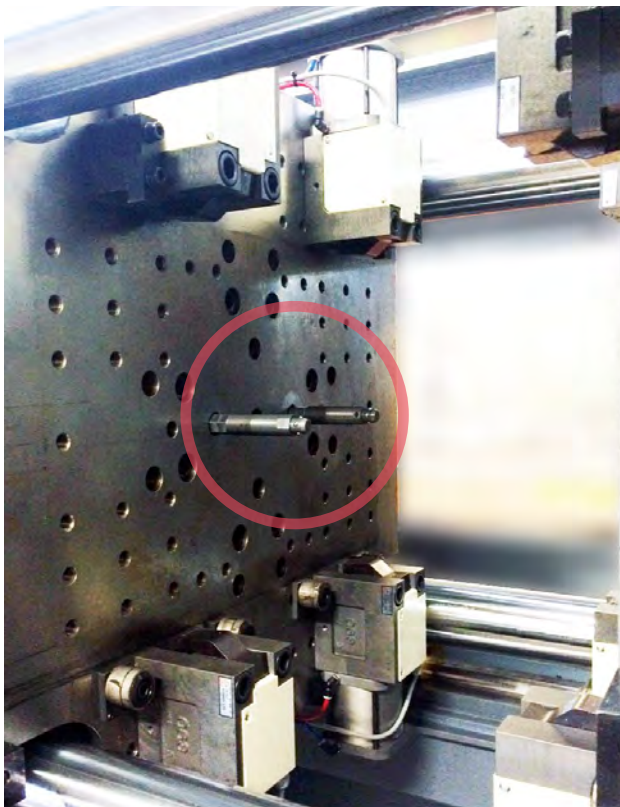

Ejector Coupler

Ejector Coupler

PMC

Center Pull Back

PMD

- Automatic connection of the extrusion plate and ejector rods reduces setup time.

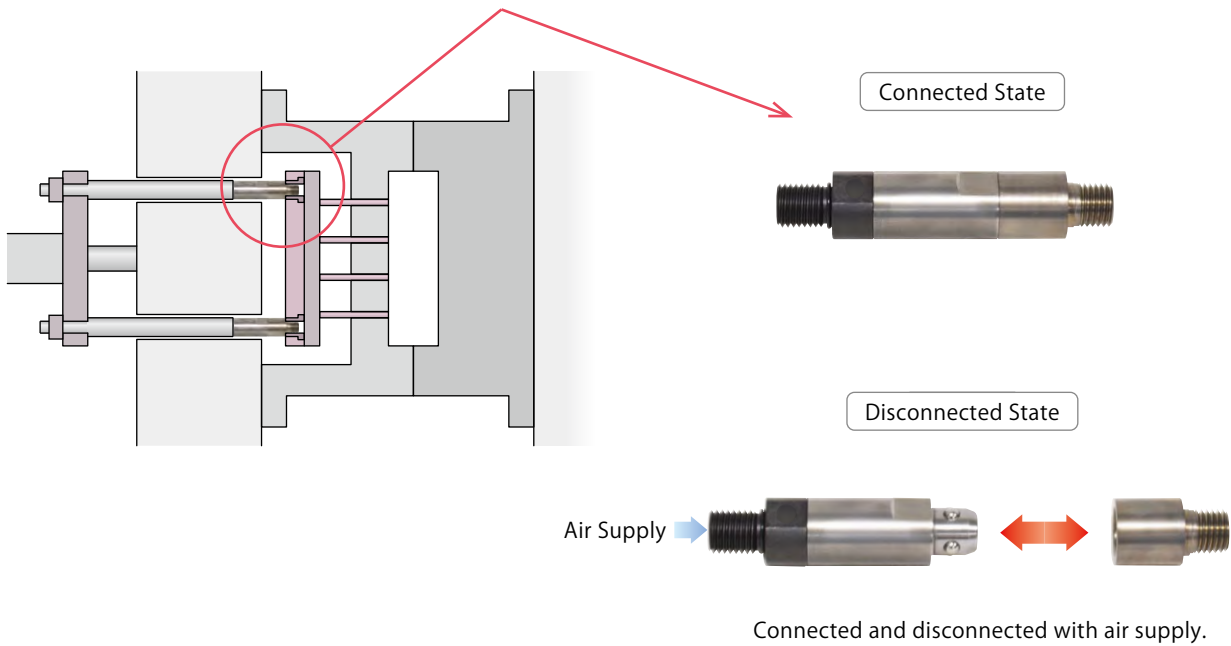

Center Pull Back

- Automatic connection with the ejector plate reduces setup time.
- Compact body with large floating for smooth connection and disconnection.

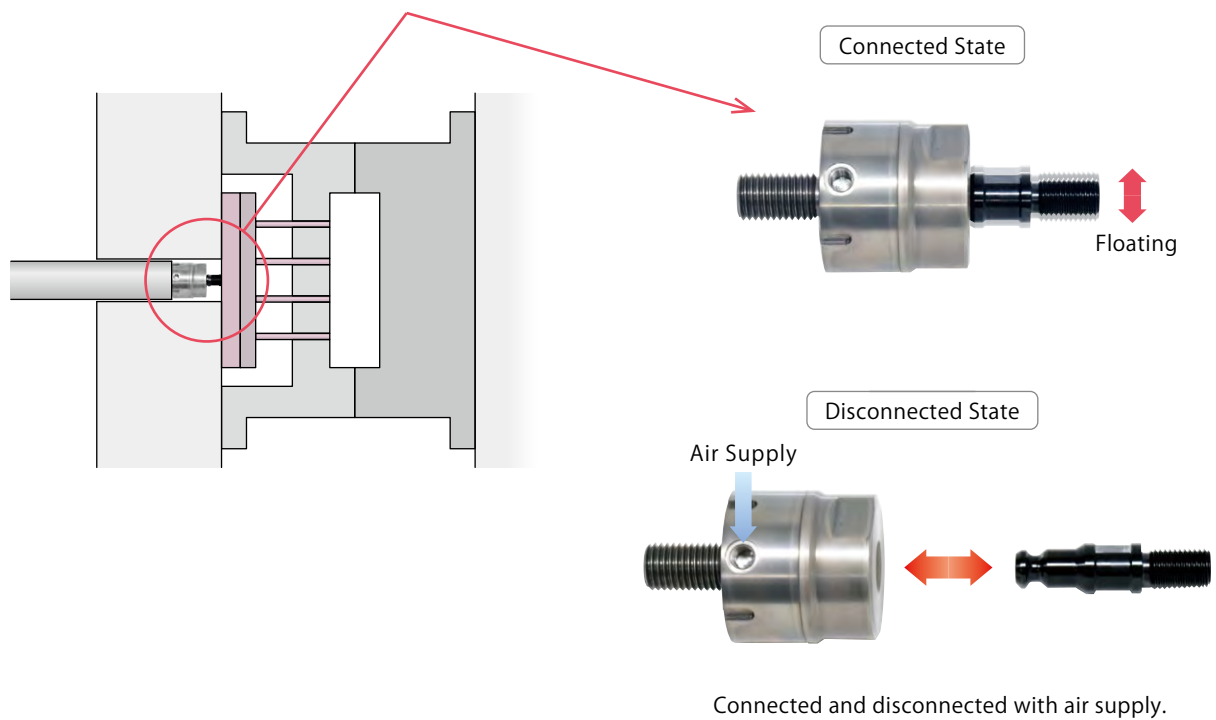

Model No. Indication

PMC 025 0 - P

1
2
3

1 Body Size

025 : Outer Diameter ϕ 25mm

030 : Outer Diameter ϕ 30mm

040 : Outer Diameter ϕ 40mm

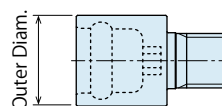

2 Design No.

0 : Revision Number

3 Classification

P : Plug

S : Socket

P : Plug



S : Socket

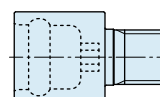

Specifications

Model No.		PMC0250	PMC0300	PMC0400
Max. Allowable Pulling Capacity	kN	10	16	25
Max. Allowable Compressive Capacity	kN	25	40	63
Release Cylinder Capacity	cm ³	0.90	1.73	3.53
Operating Air Pressure	MPa	0.3 ~ 1.0		
Withstanding Pressure	MPa	1.5		
Operating Temperature	°C	0 ~ 120		

External Dimensions : PMC

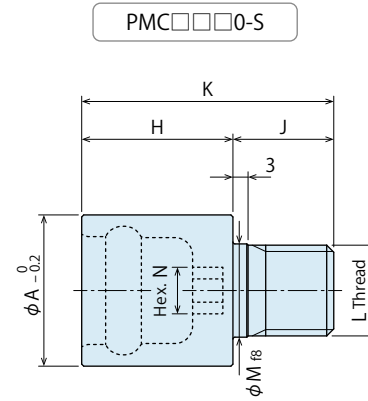
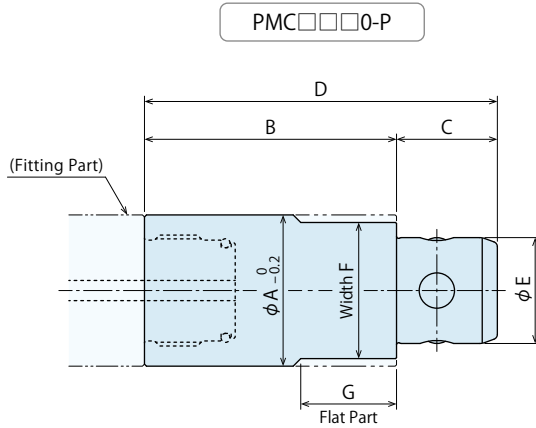

Fitting Edge Machining Dimensions

Prepared by Customer

Socket Mounting Part Machining Dimensions

Prepared by Customer

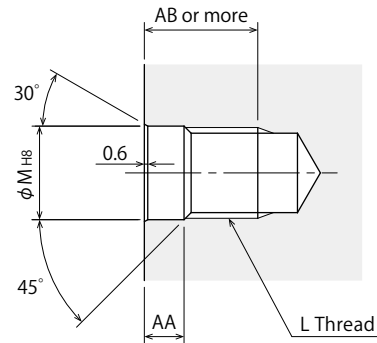
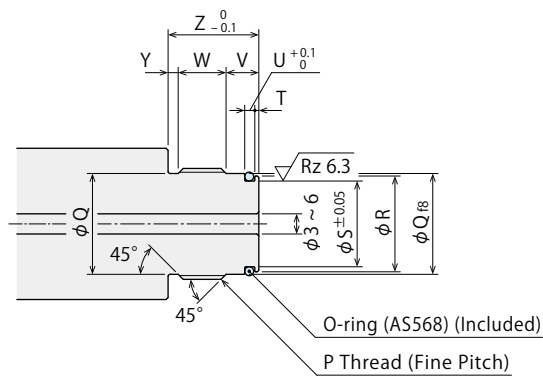

Model No.		PMC0250	PMC0300	PMC0400
Plug Dimensions	A	25	30	40
	B	45	50	55
	C	17	20	26
	D	62	70	81
	E	17.5	21	28
	F	22	27	36
	G	14	18	22
Socket Dimensions	H	25	30	38
	J	19	22	29
	K	44	52	67
	L	M16×2	M18×2.5	M24×3
	M _{f8}	16.5 ^{+0.016} _{-0.043}	18.5 ^{+0.020} _{-0.053}	24.5 ^{+0.020} _{-0.053}
	N	8	10	12
Fitting Edge Machining Dimensions	P	M18×1.5	M22×1.5	M26×1.5
	Q	16	20	24
	Q _{f8}	16 ^{+0.016} _{-0.043}	20 ^{+0.020} _{-0.053}	24 ^{+0.020} _{-0.053}
	R	15	19	23
	S	13	17	21
	T	0.8	0.8	0.8
	U	2	2	2
	V	6.5	6.5	6.5
	W	9.5	9.5	10
	Y	2	2	2
	Z	18	18	18.5
	O-ring (AS568 Series)	AS568-014 (75)	AS568-016 (75)	AS568-019 (75)
Socket Mounting Part Machining Dimensions	MH8	16.5 ^{+0.027} ₀	18.5 ^{+0.033} ₀	24.5 ^{+0.033} ₀
	AA	7	8	9
	AB	20	23	30

● Accessory : Joint for PMC

Model No. Indication

PMCZ 25 1 – J

Size
(Refer to the table)

Design No.
(Revision Number)

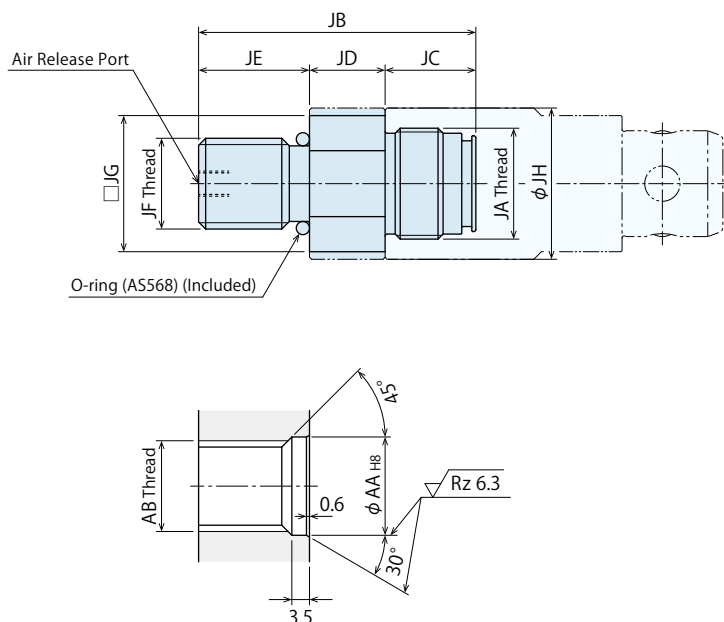

Model No.		PMCZ251-J	PMCZ301-J	PMCZ401-J
Joint Dimensions	JA	M18×1.5	M22×1.5	M26×1.5
	JB	53	55	65.5
	JC	18	18	18.5
	JD	15	15	20
	JE	20	22	27
	JF	M16×2	M18×2.5	M24×3
	JG	22	27	36
	JH	25	30	40
	O-ring (AS568 Series)	AS568-014 (75)	AS568-113 (75)	AS568-117 (75)
	Air Release Port	M5×0.8 Thread Depth 6	M5×0.8 Thread Depth 6	Rc1/8 Thread
AA		16.5 ^{+0.027} ₀	19.5 ^{+0.033} ₀	25 ^{+0.033} ₀
AB		M16×2	M18×2.5	M24×3

Ejector Coupler
PMC
Center Pull Back
PMD

● Model No. Indication

PMD

053

0

-

R

1

2

3

1 Body Size

053 : Outer Diameter ϕ 53mm
063 : Outer Diameter ϕ 63mm
078 : Outer Diameter ϕ 78mm

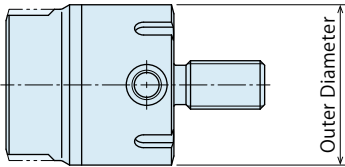

2 Design No.

0 : Revision Number

3 Classification

R : Rod
C : Coupler

R : Rod

C : Coupler

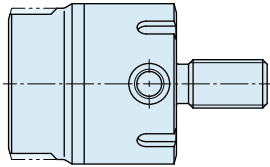
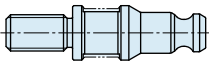

● Specifications

Model No.		PMD0530	PMD0630	PMD0780
Max. Allowable Pulling Capacity	kN	10	16	25
Max. Allowable Compressive Capacity	kN	16	25	45
Allowable Offset (Floating Amount)	mm	1.0	1.2	1.5
Release Cylinder Capacity	cm ³	5.26	8.31	15.36
Operating Air Pressure	MPa	0.3 ~ 1.0		
Withstanding Pressure	MPa	1.5		
Operating Temperature	℃	0 ~ 120		

External Dimensions : PMD

PMD□□□0-R

PMD□□□0-C

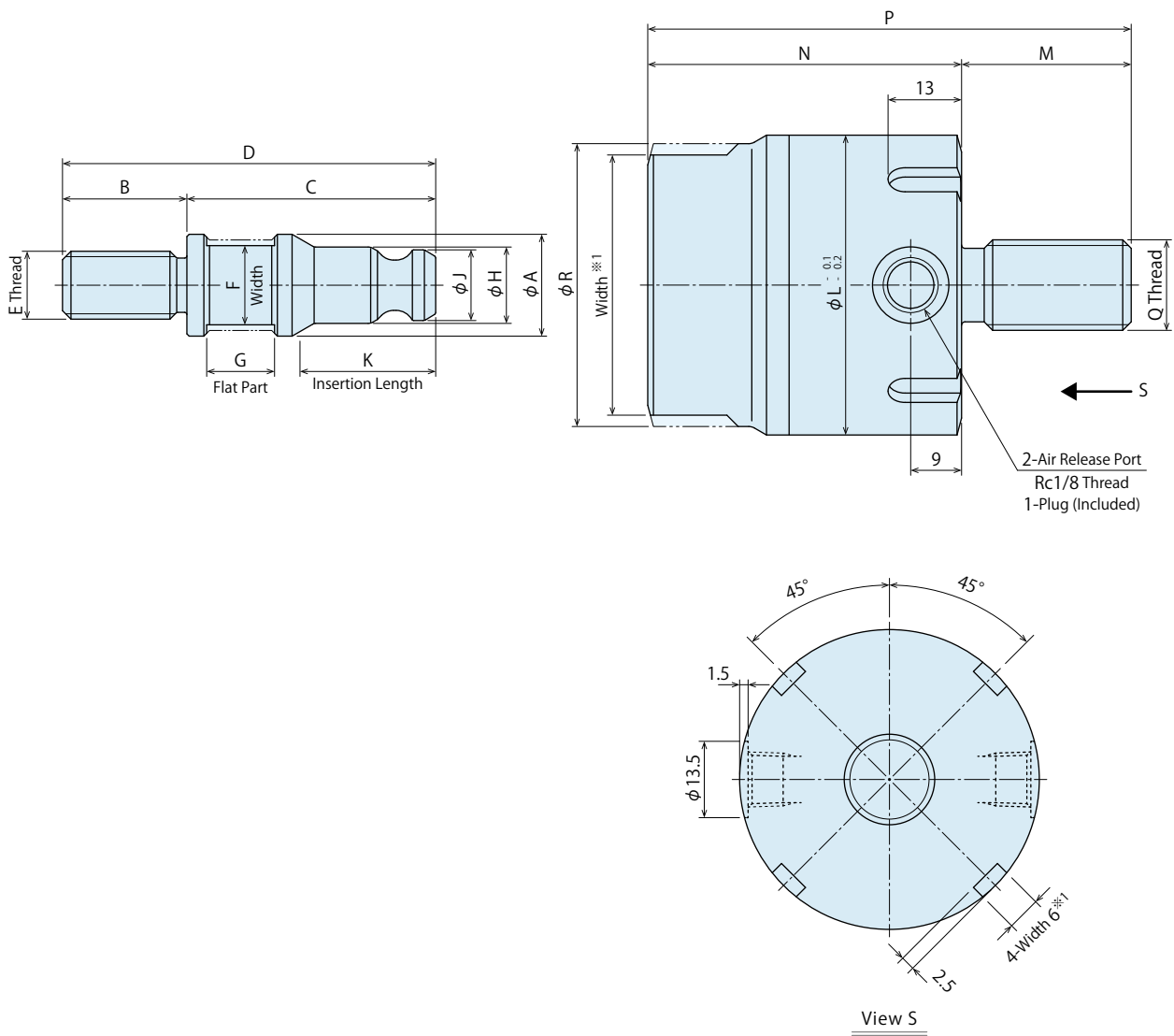

Model No.		PMD0530	PMD0630	PMD0780
Rod Dimensions	A	18	21	28
	B	22	28	35
	C	44	52	70
	D	66	80	105
	E	M12×1.75	M16×2	M20×2.5
	F	14	17	22
	G	12	14.5	19
	H	13.5	16.5	21.5
	J	12.5	15.5	20.5
	K	24	27.5	35.5
Coupler Dimensions	L	53	63	78
	M	30	35	45
	N	55.5	60	72.5
	P	85.5	95	117.5
	Q	M16×2	M20×2.5	M24×3
	R	50	60	75

Note :

※1. Use the slot of Width 6 to mount and remove a coupler with hook spanner. If using flat part it may lead to damage or injury.

Ejector Coupler

PMC

Center Pull Back

PMD

Cautions

Notes for Design

- 1) Check specifications. (PMC : Page 3, PMD : Page 7)
- Machines and devices should be operated and maintained by qualified personnel.
- 2) Do not connect the coupler when it is contaminated.
- When each end of the coupler is contaminated, remove contaminants with air blow. Otherwise it cannot be connected properly.

Installation Notes

- 1) Please supply clean dry air.
 - Install an air filter/air dryer in order to prevent rust and dirt. Otherwise it may lead to malfunction.
- 2) Procedure before Piping
 - The pipeline and piping connector should be cleaned by thorough flushing. The dust and cutting chips in the circuit may lead to air leakage and malfunction.
(The filter which removes contaminant in the air circuit is not provided.)
- 3) Applying Sealing Tape
 - Wrap with tape 1 to 2 times following the screwing direction. When piping, be careful that contaminants such as sealing tape do not enter in products. Pieces of the sealing tape can lead to air leaks and malfunction.
- 4) Installation of the Product
 - For installation of the plug (coupler) body and socket (rod), tighten them with tightening torque $100\text{N} \cdot \text{m}$.

Notes on Handling

- 1) It should be operated by qualified personnel.
- 2) Do not operate or remove the product unless the safety protocols are ensured.
 - ① The machine and equipment can only be inspected or prepared when it is confirmed that the safety devices are in place.
 - ② Before the product is removed, make sure that the above-mentioned safety devices are in place. Shut off the pressure and power source, and make sure no pressure exists in the air and hydraulic circuits.
 - ③ After stopping the product, do not remove until the temperature drops.
 - ④ Make sure there is no abnormality in the bolts and respective parts before restarting the machine or equipment.
- 3) Do not disassemble or modify.
 - If the equipment is taken apart or modified, the warranty will be voided even within the warranty period.
- 4) Do not touch the coupler while it is working.
 - Otherwise, your hands may be injured due to clinching.

【Air Circuit Sample】

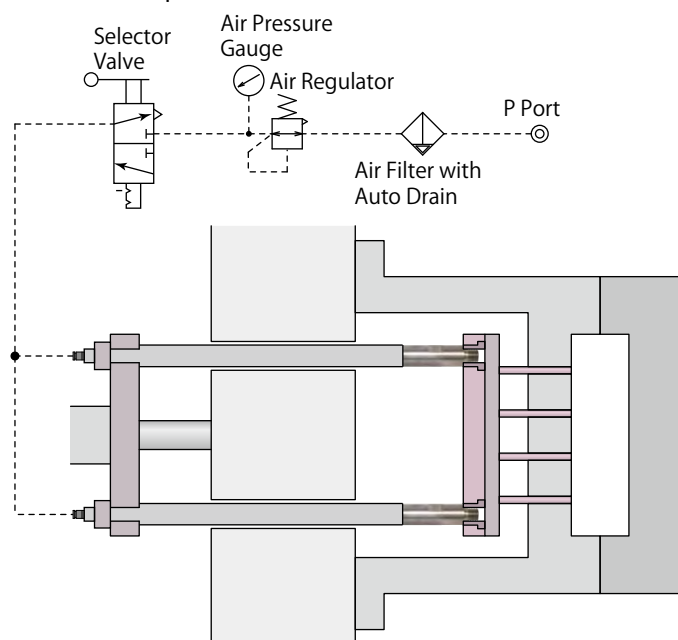

※ Select the selector valve according to customer's usage.

● Maintenance / Inspection

- 1) Removal of the Product and Shut-off of Air Pressure Source
 - Before the product is removed, make sure that safety devices and preventive devices are in place. Shut off the pressure and power source, and make sure no pressure exists in the air circuits.
Make sure there is no abnormality in the bolts and respective parts before restarting.
- 2) Regularly clean the area around the pipe, plug body and socket.
- 3) Periodically ensure that supply air pressure is a specified value.
- 4) Make sure to supply filtered clean dry air.
- 5) Make sure there is a smooth action without an irregular noise.
 - Especially when it is restarted after left unused for a long period, make sure it can be operated correctly.
- 6) The products should be stored in the cool and dark place without direct sunshine or moisture.
- 7) Please contact us for overhaul and repair.

● Warranty

- 1) Warranty Period
 - The product warranty period is 18 months from shipment from our factory or 12 months from initial use, whichever is earlier.
- 2) Warranty Scope
 - If the product is damaged or malfunctions during the warranty period due to faulty design, materials or workmanship, we will replace or repair the defective part at our expense.
Defects or failures caused by the following are not covered.
 - ① If the stipulated maintenance and inspection are not carried out.
 - ② If the product is used while it is not suitable for use based on the operator's judgment, resulting in defect.
 - ③ If it is used or operated in an inappropriate way by the operator. (Including damage caused by the misconduct of the third party.)
 - ④ If the defect is caused by reasons other than our responsibility.
 - ⑤ If repair or modifications are carried out by anyone other than Kosmek, or without our approval and confirmation, it will void warranty.
 - ⑥ Other caused by natural disasters or calamities not attributable to our company.
 - ⑦ Parts or replacement expenses due to parts consumption and deterioration.
(Such as rubber, plastic, seal material and some electric components.)

Damages excluding from direct result of a product defect shall be excluded from the warranty.



KOSMEK LTD.

► <https://www.kosmek.com/>

HEAD OFFICE 1-5, 2-chome, Murotani, Nishi-ku, Kobe-city, Hyogo, Japan 651-2241
TEL.+81-78-991-5162 FAX.+81-78-991-8787

United States of America SUBSIDIARY	KOSMEK (USA) LTD. 650 Springer Drive, Lombard, IL 60148 USA TEL. +1-630-620-7650 FAX. +1-630-620-9015
MEXICO REPRESENTATIVE OFFICE	KOSMEK USA Mexico Office Av. Santa Fe 103, Int. 59, col. Santa Fe Juriquilla, Queretaro, QRO, 76230, Mexico TEL. +52-442-851-1377
EUROPE SUBSIDIARY	KOSMEK EUROPE GmbH Schleppeplatz 2 9020 Klagenfurt am Wörthersee Austria TEL. +43-463-287587 FAX. +43-463-287587-20
CHINA SUBSIDIARY	KOSMEK (CHINA) LTD. Room601, RIVERSIDE PYRAMID No.55, Lane21, Pusan Rd, Pudong Shanghai 200125, China TEL. +86-21-54253000
INDIA BRANCH OFFICE	KOSMEK LTD. - INDIA 4A/Old No:649, Ground Floor, 4th D cross, MM Layout, Kavalbyrasandra, RT Nagar, Bangalore -560032 India TEL.+91-9880561695
THAILAND REPRESENTATIVE OFFICE	KOSMEK Thailand Representation Office 67 Soi 58, RAMA 9 Rd., Phatthanakan, Suanluang, Bangkok 10250, Thailand TEL. +66-2-300-5132 FAX. +66-2-300-5133

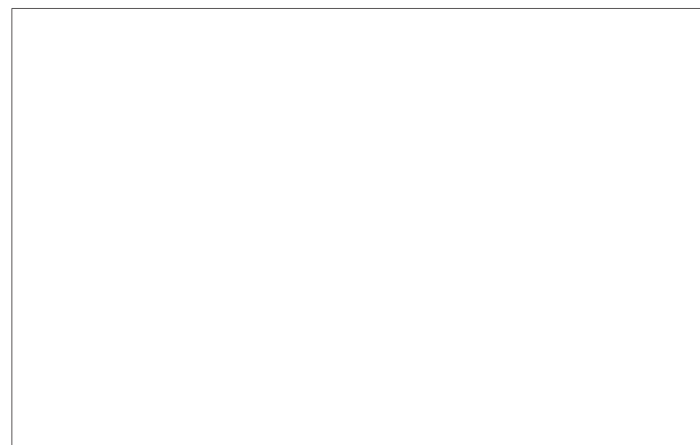

- For Further Information on Unlisted Specifications and Sizes, Please call us.
- Specifications in this Leaflet are Subject to Change without Notice.



KOSMEK HEAD OFFICE

